

KHU 80

Soporte, pesado, 80x60 mm

Soporte con perfil en U de 80x60x5 mm, perforaciones continuas en tres lados.

Gracias al refuerzo, se pueden alcanzar mayores capacidades de carga.

Galvanizado por inmersión en caliente según DIN EN ISO 1461

| Product | H | B | L | G |
|------------|-------|-------|---------|----------|
| KHU 80-02F | 80 mm | 60 mm | 200 mm | 1,33 kg |
| KHU 80-03F | 80 mm | 60 mm | 300 mm | 2,00 kg |
| KHU 80-04F | 80 mm | 60 mm | 400 mm | 2,66 kg |
| KHU 80-05F | 80 mm | 60 mm | 500 mm | 3,33 kg |
| KHU 80-06F | 80 mm | 60 mm | 600 mm | 3,99 kg |
| KHU 80-07F | 80 mm | 60 mm | 700 mm | 4,66 kg |
| KHU 80-08F | 80 mm | 60 mm | 800 mm | 5,32 kg |
| KHU 80-09F | 80 mm | 60 mm | 900 mm | 5,99 kg |
| KHU 80-10F | 80 mm | 60 mm | 1000 mm | 6,65 kg |
| KHU 80-11F | 80 mm | 60 mm | 1100 mm | 7,32 kg |
| KHU 80-12F | 80 mm | 60 mm | 1200 mm | 7,98 kg |
| KHU 80-13F | 80 mm | 60 mm | 1300 mm | 8,65 kg |
| KHU 80-14F | 80 mm | 60 mm | 1400 mm | 9,32 kg |
| KHU 80-15F | 80 mm | 60 mm | 1500 mm | 9,98 kg |
| KHU 80-16F | 80 mm | 60 mm | 1600 mm | 10,65 kg |
| KHU 80-17F | 80 mm | 60 mm | 1700 mm | 11,31 kg |
| KHU 80-18F | 80 mm | 60 mm | 1800 mm | 11,98 kg |
| KHU 80-19F | 80 mm | 60 mm | 1900 mm | 12,64 kg |
| KHU 80-20F | 80 mm | 60 mm | 2000 mm | 13,31 kg |
| KHU 80-30F | 80 mm | 60 mm | 3000 mm | 19,96 kg |
| KHU 80-60F | 80 mm | 60 mm | 6000 mm | 39,92 kg |



H: Altura
B: Anchura
L: Longitud
G: Peso

DETAILS / APPLICATIONS

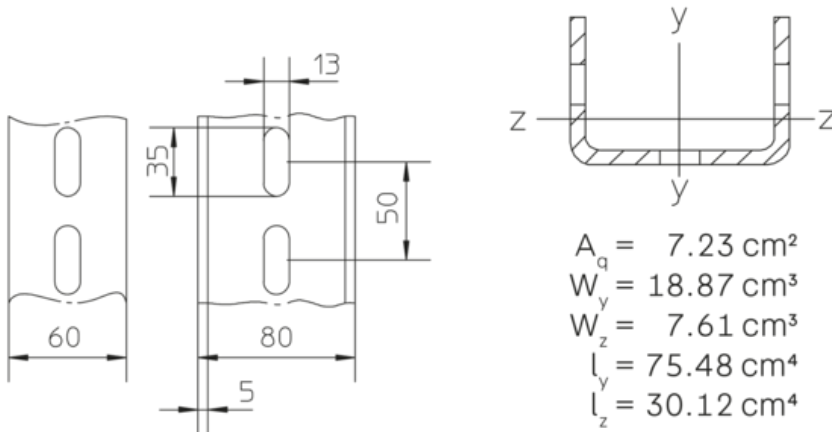

OPTIONAL ACCESSORIES

BGU 80, KHUV 80, KHUSS 80, KW, KLS, SU 80, WPHS-P

