

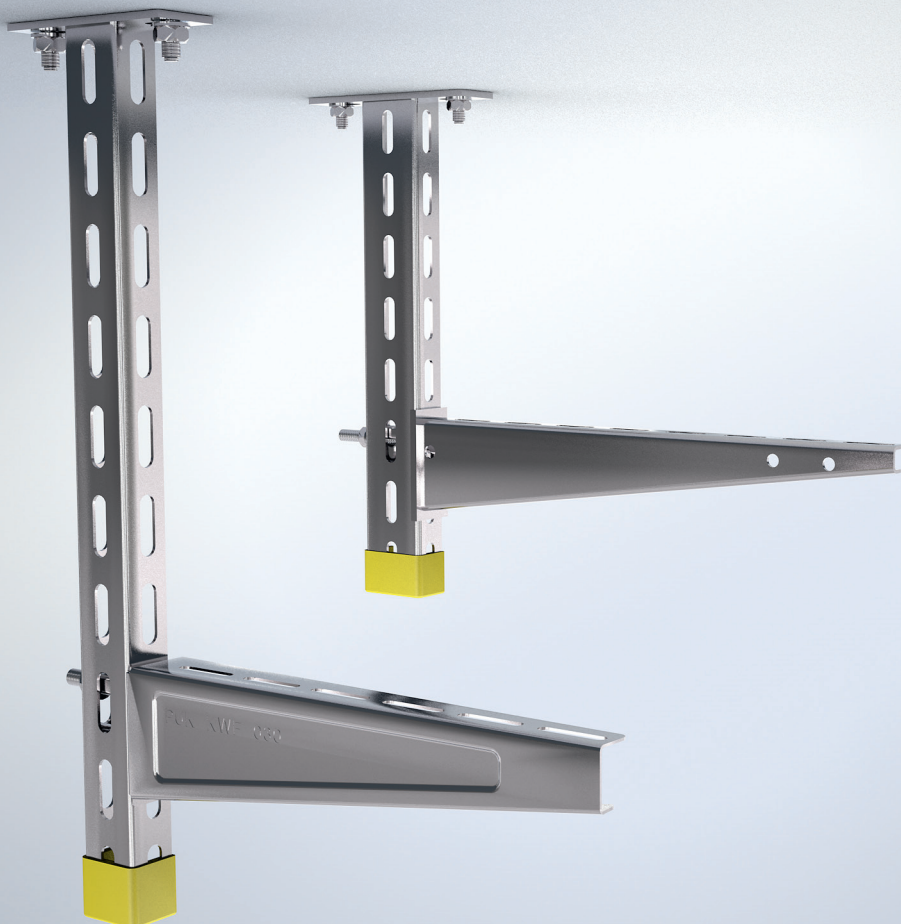

Bracket support for light duty support systems Information



Light weight champions.

From now on we are offering you two types of three-sided bracket supports – namely light and medium duty. It is the new generation of our light duty bracket support. The KDU / KHU 40 is the best choice for light duty support and the KDU / KHU 57 for medium duty support.

What is best for you & what do you need to know:

We have reduced our product range, but can now offer you a more complex variety of load capacities within our product line meeting your needs. Therefore the installation will be more consistent.

The established bracket supports KUL, KUM and KUS will therefore be removed from our catalogues.

The load capacities are more defined with this support system and the KHUSS support plate was optimized to fit the new bracket support.

For installation systems according to the fire prevention (DIN 4102-12), certified without threaded rod you can now use the KDU 52.

The certificate is valid for the cable producers as listed below (cable types according to the certificate ABP P-MPA-E-15-019:

- Dätwyler
- Kabelwerk Eupen
- Leoni Studer

That's new.

KDU 40 KDU 40 bracket support, 40 x 30mm

Ceiling bracket support, U-profile 40 x 30mm, continuously three-way perforated, with welded head plate, certified according to DIN EN 61537.

Load figures P_{max} when using a support piece with the hot-dip galvanized Bracket support according to DIN EN 61537 (test No. 10.8.2.3). It is recommended to apply the support piece from a bracket width of 400mm or if the bracket is installed at the end of the ceiling fixed bracket.

article number	L mm	G kg
F		
KDU 40-02F	200	0,38
KDU 40-03F	300	0,50
KDU 40-04F	400	0,62
KDU 40-05F	500	0,73
KDU 40-06F	600	0,86
KDU 40-07F	700	0,98
KDU 40-08F	800	1,10
KDU 40-09F	900	1,22
KDU 40-10F	1000	1,34
KDU 40-11F	1100	1,46
KDU 40-12F	1200	1,58
KDU 40-13F	1300	1,70
KDU 40-14F	1400	1,82
KDU 40-15F	1500	1,94
E		
KDU 40-02E	200	0,36
KDU 40-03E	300	0,47
KDU 40-04E	400	0,60
KDU 40-05E	500	0,70
KDU 40-06E	600	0,81
KDU 40-07E	700	0,92
KDU 40-08E	800	1,03
KDU 40-09E	900	1,15
KDU 40-10E	1000	1,26
KDU 40-11E	1100	1,40
KDU 40-12E	1200	1,50
KDU 40-13E	1300	1,60
KDU 40-14E	1400	1,73
KDU 40-15E	1500	1,83
E4		
KDU 40-02E4	200	0,36
KDU 40-03E4	300	0,47
KDU 40-04E4	400	0,60
KDU 40-05E4	500	0,70
KDU 40-06E4	600	0,81
KDU 40-07E4	700	0,92
KDU 40-08E4	800	1,03
KDU 40-09E4	900	1,16
KDU 40-10E4	1000	1,26
KDU 40-11E4	1100	1,40
KDU 40-12E4	1200	1,50
KDU 40-13E4	1300	1,61
KDU 40-14E4	1400	1,73
KDU 40-15E4	1500	1,84

accessories optional:

KWF	bracket, light
KW	bracket, standard
KHU 40	KHU 40 bracket support, 40 x 30mm
KHUV 40	coupler
KHUSS 40	support piece
SU 40	protection cap

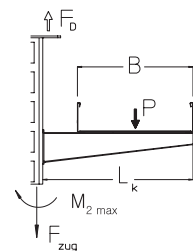
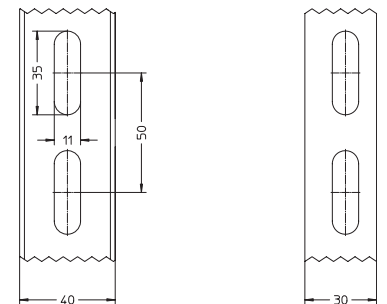
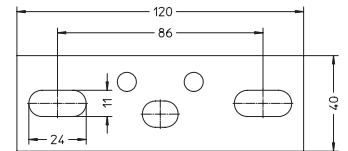
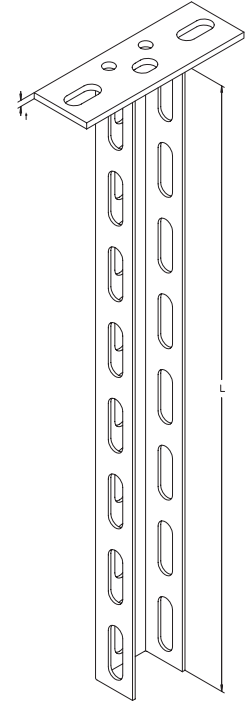

$$M_{2 \max} = 380 \text{ Nm}$$

$$F_{\text{zug}} = 10 \text{ kN}$$

B mm	L _k mm	P _{max} kN	F _D /P
100	120	4,3	1,6
200	220	2,7	2,1
300	320	2,0	2,7
400	420	1,5	3,3

That's new.

KDU 57 KDU 57 bracket support, 57 x 30mm

Ceiling bracket support, U-profile 57 x 30mm, continuously three-way perforated, with welded head plate, certified according to DIN EN 61537.

Load figures P_{max} when using a support piece with the hot-dip galvanized Bracket support according to DIN EN 61537 (test No. 10.8.2.3). It is recommended to apply the support piece from a bracket width of 400mm or if the bracket is installed at the end of the ceiling fixed bracket. For the system-tested circuit integrity maintenance the support piece KHUSS 60 must be used.

article number	L mm	G kg
F		
KDU 57-02F	200	0,59
KDU 57-03F	300	0,77
KDU 57-04F	400	0,95
KDU 57-05F	500	1,13
KDU 57-06F	600	1,31
KDU 57-07F	700	1,49
KDU 57-08F	800	1,68
KDU 57-09F	900	1,86
KDU 57-10F	1000	2,04
KDU 57-11F	1100	2,22
KDU 57-12F	1200	2,40
KDU 57-13F	1300	2,58
KDU 57-14F	1400	2,77
KDU 57-15F	1500	2,95
E		
KDU 57-02E	200	0,57
KDU 57-03E	300	0,74
KDU 57-04E	400	0,91
KDU 57-05E	500	1,08
KDU 57-06E	600	1,25
KDU 57-07E	700	1,42
KDU 57-08E	800	1,59
KDU 57-09E	900	1,76
KDU 57-10E	1000	1,93
KDU 57-11E	1100	2,10
KDU 57-12E	1200	2,27
KDU 57-13E	1300	2,44
KDU 57-14E	1400	2,61
KDU 57-15E	1500	2,78

accessories optional:

KWF	bracket, light
KW	bracket, standard
KWMS	wall bracket, medium heavy
KHU 57	KHU 40 bracket support, 57 x 30mm
KHUV 57	coupler
KHUSS 57	support piece
SU 57	protection cap

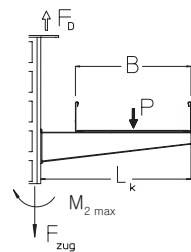
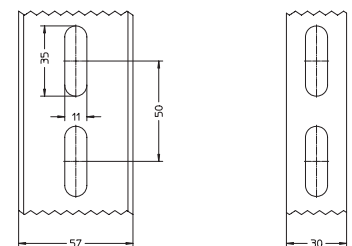
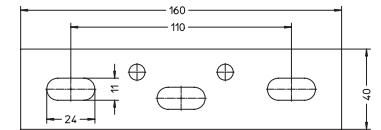
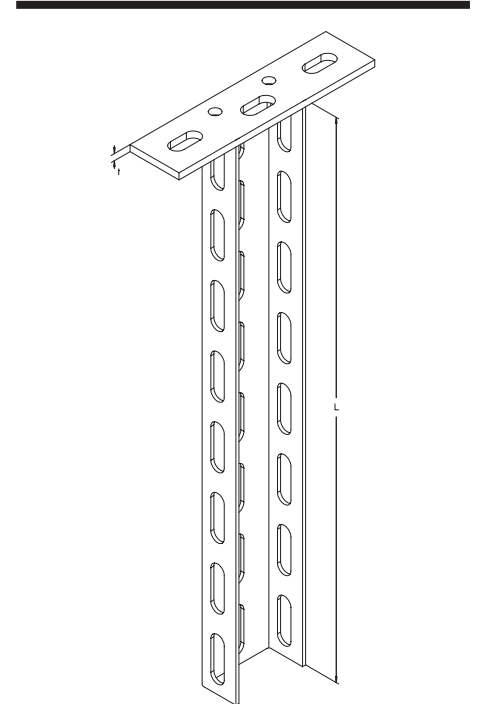

$$M_{2 \max} = 670 \text{ Nm}$$

$$F_{\text{zug}} = 15 \text{ kN}$$

B mm	L_k mm	P_{\max} kN	F_D/P
100	120	6,9	1,4
200	220	4,5	1,9
300	320	3,4	2,3
400	420	2,7	2,8
500	520	2,2	3,2
600	620	1,9	3,7

KDU 57 KDU 57 bracket support, 57 x 30mm

Ceiling bracket support, U-profile 57 x 30mm, continuously three-way perforated, with welded head plate, certified according to DIN EN 61537.

Load figures P_{max} when using a support piece with the hot-dip galvanized Bracket support according to DIN EN 61537 (test No. 10.8.2.3). It is recommended to apply the support piece from a bracket width of 400mm or if the bracket is installed at the end of the ceiling fixed bracket. For the system-tested circuit integrity maintenance the support piece KHUSS 60 must be used.

article number	L mm	G kg
E4		
KDU 57-02E4	200	0,57
KDU 57-03E4	300	0,74
KDU 57-04E4	400	0,91
KDU 57-05E4	500	1,08
KDU 57-06E4	600	1,25
KDU 57-07E4	700	1,42
KDU 57-08E4	800	1,59
KDU 57-09E4	900	1,76
KDU 57-10E4	1000	1,93
KDU 57-11E4	1100	2,10
KDU 57-12E4	1200	2,27
KDU 57-13E4	1300	2,44
KDU 57-14E4	1400	2,61
KDU 57-15E4	1500	2,78

accessories optional:

KWF	bracket, light
KW	bracket, standard
KWMS	wall bracket, medium heavy
KHU 57	KHU 40 bracket support, 57 x 30mm
KHUV 57	coupler
KHUSS 57	support piece
SU 57	protection cap

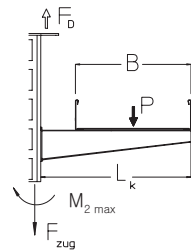
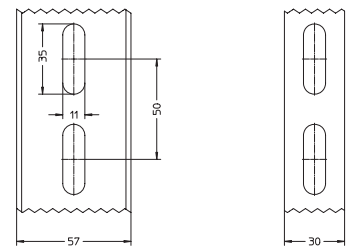
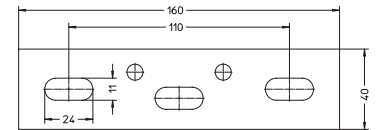
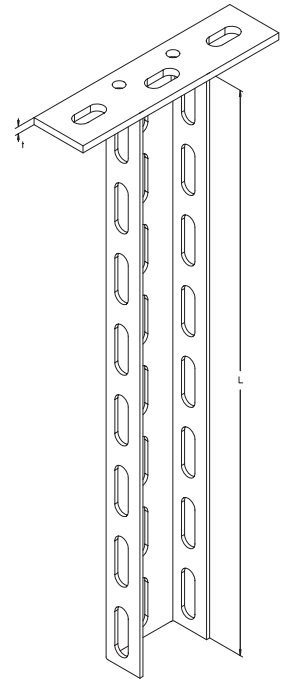

$$M_{2 \max} = 670 \text{ Nm}$$

$$F_{\text{zug}} = 15 \text{ kN}$$

B mm	L_k mm	P_{\max} kN	F_D/P
100	120	6,9	1,4
200	220	4,5	1,9
300	320	3,4	2,3
400	420	2,7	2,8
500	520	2,2	3,2
600	620	1,9	3,7

That's new.

KHU 40 KHU 40 bracket support, 40 x 30mm

Ceiling bracket support, U-profile 40 x 30mm, continuously three-way perforated.

It is recommended to apply the support piece from a bracket width of 400mm or if the bracket is installed at the end of the ceiling fixed bracket.

article number	L mm	G kg
S		
KHU 40-02S	200	0,22
KHU 40-03S	300	0,34
KHU 40-04S	400	0,45
KHU 40-05S	500	0,56
KHU 40-06S	600	0,67
KHU 40-07S	700	0,79
KHU 40-08S	800	0,90
KHU 40-09S	900	1,01
KHU 40-10S	1000	1,12
KHU 40-11S	1100	1,23
KHU 40-12S	1200	1,35
KHU 40-13S	1300	1,55
KHU 40-14S	1400	1,60
KHU 40-15S	1500	1,70
KHU 40-30S	3000	3,40
KHU 40-60S	6000	6,73

F		
KHU 40-02F	200	0,24
KHU 40-03F	300	0,36
KHU 40-04F	400	0,48
KHU 40-05F	500	0,60
KHU 40-06F	600	0,72
KHU 40-07F	700	0,84
KHU 40-08F	800	0,96
KHU 40-09F	900	1,10
KHU 40-10F	1000	1,20
KHU 40-11F	1100	1,32
KHU 40-12F	1200	1,44
KHU 40-13F	1300	1,60
KHU 40-14F	1400	1,70
KHU 40-15F	1500	1,80
KHU 40-30F	3000	3,60
KHU 40-60F	6000	7,20

accessories optional:

KDU 40 KDU 40 bracket support, 40 x 30mm

BGU 40 head plate, profile U40

KWF bracket, light

KW bracket, standard

KHUV 40 coupler

KHUSS 40 support piece

SU 40 protection cap

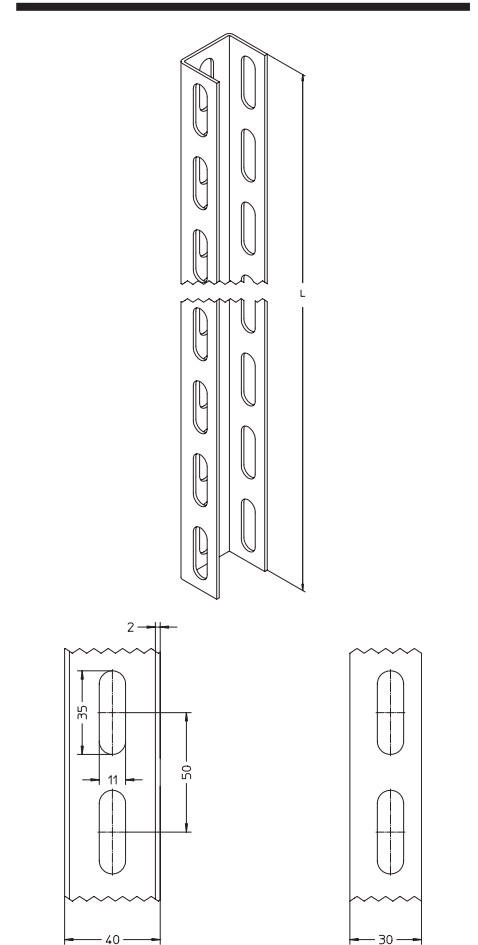

KHU 57 KHU 40 bracket support, 57 x 30mm

Ceiling bracket support, U-profile 40 x 30mm, continuously three-way perforated.

It is recommended to apply the support piece from a bracket width of 400mm or if the bracket is installed at the end of the ceiling fixed bracket.

article number	L mm	G kg
S		
KHU 57-02S	200	0,34
KHU 57-03S	300	0,51
KHU 57-04S	400	0,68
KHU 57-05S	500	0,85
KHU 57-06S	600	1,02
KHU 57-07S	700	1,19
KHU 57-08S	800	1,36
KHU 57-09S	900	1,53
KHU 57-10S	1000	1,70
KHU 57-11S	1100	1,87
KHU 57-12S	1200	2,04
KHU 57-13S	1300	2,21
KHU 57-14S	1400	2,38
KHU 57-15S	1500	2,55
KHU 57-30S	3000	5,09
KHU 57-60S	6000	10,18

F		
KHU 57-02F	200	0,36
KHU 57-03F	300	0,55
KHU 57-04F	400	0,73
KHU 57-05F	500	0,91
KHU 57-06F	600	1,09
KHU 57-07F	700	1,27
KHU 57-08F	800	1,45
KHU 57-09F	900	1,63
KHU 57-10F	1000	1,82
KHU 57-11F	1100	2,00
KHU 57-12F	1200	2,18
KHU 57-13F	1300	2,36
KHU 57-14F	1400	2,54
KHU 57-15F	1500	2,72
KHU 57-30F	3000	5,45
KHU 57-60F	6000	10,89

accessories optional:

BGU 57	head plate, profile U57
KWF	bracket, light
KW	bracket, standard
KWMS	wall bracket, medium heavy
KDU 57	KDU 57 bracket support, 57 x 30mm
KHUV 57	coupler
KHUSS 57	support piece
SU 57	protection cap

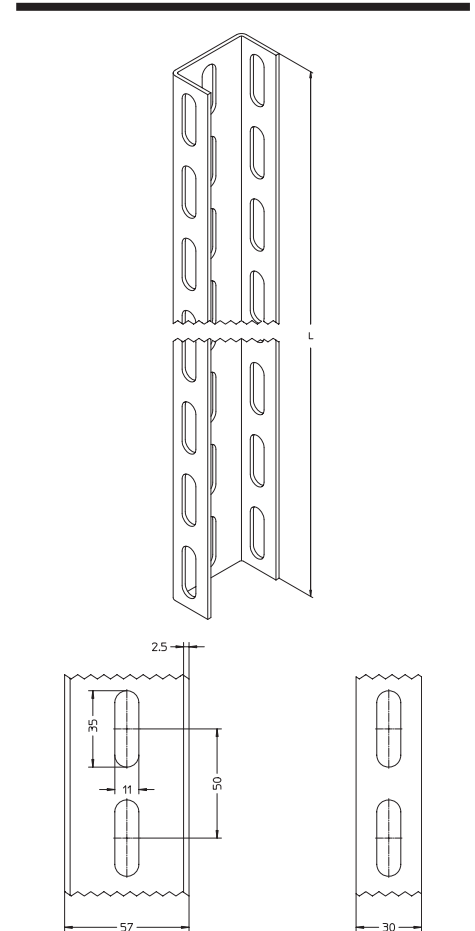

That's new.

KHU 57 KHU 40 bracket support, 57 x 30mm

Ceiling bracket support, U-profile 40 x 30mm, continuously three-way perforated.

It is recommended to apply the support piece from a bracket width of 400mm or if the bracket is installed at the end of the ceiling fixed bracket.

article number	L mm	G kg
S		
KHU 57-02S	200	0,34
KHU 57-03S	300	0,51
KHU 57-04S	400	0,68
KHU 57-05S	500	0,85
KHU 57-06S	600	1,02
KHU 57-07S	700	1,19
KHU 57-08S	800	1,36
KHU 57-09S	900	1,53
KHU 57-10S	1000	1,70
KHU 57-11S	1100	1,87
KHU 57-12S	1200	2,04
KHU 57-13S	1300	2,21
KHU 57-14S	1400	2,38
KHU 57-15S	1500	2,55
KHU 57-30S	3000	5,09
KHU 57-60S	6000	10,18

F		
KHU 57-02F	200	0,36
KHU 57-03F	300	0,55
KHU 57-04F	400	0,73
KHU 57-05F	500	0,91
KHU 57-06F	600	1,09
KHU 57-07F	700	1,27
KHU 57-08F	800	1,45
KHU 57-09F	900	1,63
KHU 57-10F	1000	1,82
KHU 57-11F	1100	2,00
KHU 57-12F	1200	2,18
KHU 57-13F	1300	2,36
KHU 57-14F	1400	2,54
KHU 57-15F	1500	2,72
KHU 57-30F	3000	5,45
KHU 57-60F	6000	10,89

accessories optional:

BGU 57	head plate, profile U57
KWF	bracket, light
KW	bracket, standard
KWMS	wall bracket, medium heavy
KDU 57	KDU 57 bracket support, 57 x 30mm
KHUV 57	coupler
KHUSS 57	support piece
SU 57	protection cap

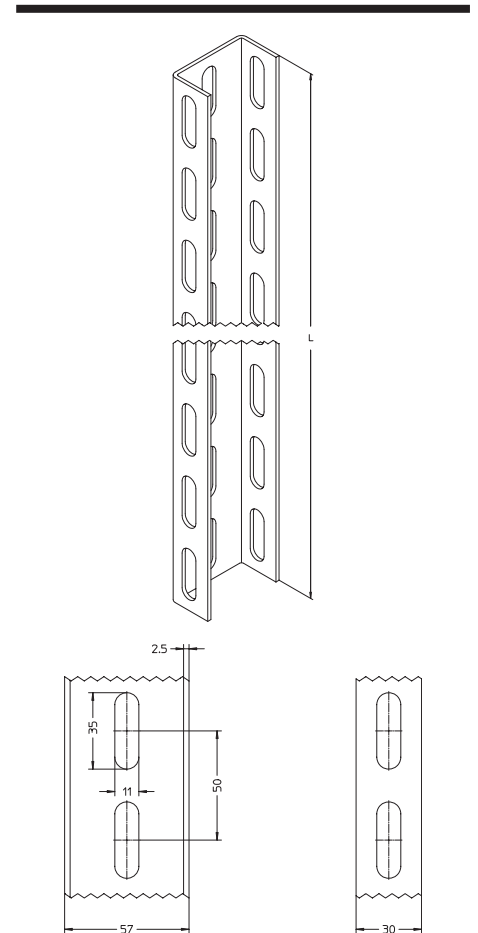

KHU 57 KHU 40 bracket support, 57 x 30mm

Ceiling bracket support, U-profile 40 x 30mm, continuously three-way perforated.

It is recommended to apply the support piece from a bracket width of 400mm or if the bracket is installed at the end of the ceiling fixed bracket.

article number	L mm	G kg
E		
KHU 57-02E	200	0,34
KHU 57-03E	300	0,51
KHU 57-04E	400	0,68
KHU 57-05E	500	0,85
KHU 57-06E	600	1,03
KHU 57-07E	700	1,20
KHU 57-08E	800	1,37
KHU 57-09E	900	1,54
KHU 57-10E	1000	1,71
KHU 57-11E	1100	1,88
KHU 57-12E	1200	2,05
KHU 57-13E	1300	2,22
KHU 57-14E	1400	2,39
KHU 57-15E	1500	2,56
KHU 57-30E	3000	5,12
KHU 57-60E	6000	10,25

E4		
KHU 57-02E4	200	0,35
KHU 57-03E4	300	0,52
KHU 57-04E4	400	0,69
KHU 57-05E4	500	0,87
KHU 57-06E4	600	1,04
KHU 57-07E4	700	1,21
KHU 57-08E4	800	1,38
KHU 57-09E4	900	1,56
KHU 57-10E4	1000	1,73
KHU 57-11E4	1100	1,90
KHU 57-12E4	1200	2,08
KHU 57-13E4	1300	2,25
KHU 57-14E4	1400	2,42
KHU 57-15E4	1500	2,59
KHU 57-30E4	3000	5,19
KHU 57-60E4	6000	10,38

accessories optional:

BGU 57	head plate, profile U57
KWF	bracket, light
KW	bracket, standard
KWMS	wall bracket, medium heavy
KDU 57	KDU 57 bracket support, 57 x 30mm
KHUV 57	coupler
KHUSS 57	support piece
SU 57	protection cap

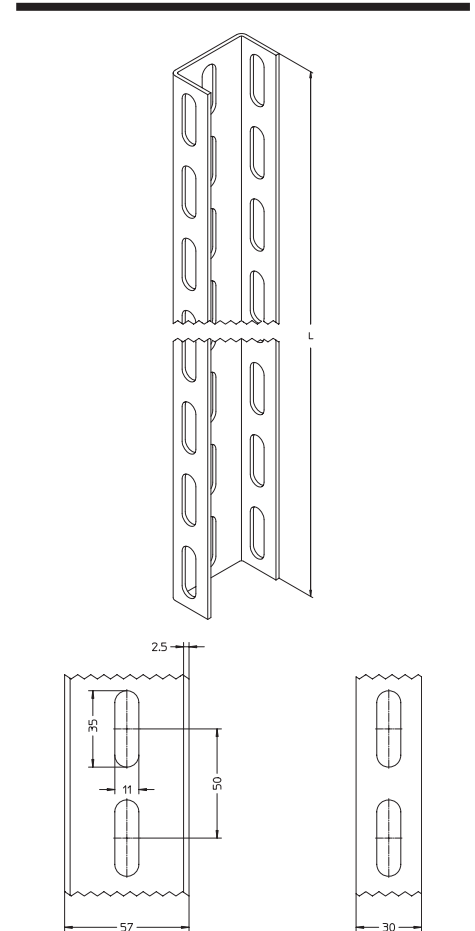

That's new.

BGU 40 head plate, profile U40

Head plate for ceiling mounting of bracket support KHU 40

article number	H mm	B mm	L mm	t mm	G kg
F					
BGU 40F	100	40	120	4	0,37

accessories included:

- 2 x **FRSV 10x20F** cup square neck bolt
- 2 x **US 10x21F** Square washer, DIN 125
- 2 x **SEM 10F** hexagon-nut, DIN 934

article number	H mm	B mm	L mm	t mm	G kg
E					
BGU 40E	100	40	120	4	0,35

accessories included:

- 2 x **FRSV 10x20E** cup square neck bolt
- 2 x **US 10x21E** Square washer, DIN 125
- 2 x **SEM 10E** hexagon-nut, DIN 934

article number	H mm	B mm	L mm	t mm	G kg
E4					
BGU 40E4	100	40	120	4	0,35

accessories included:

- 2 x **FRSV 10x20E4** cup square neck bolt
- 2 x **US 10x21E4** Square washer, DIN 125
- 2 x **SEM 10E4** hexagon-nut, DIN 934

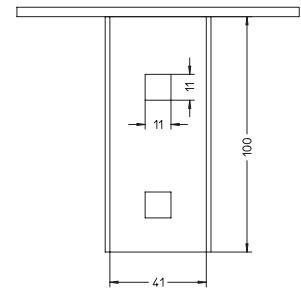
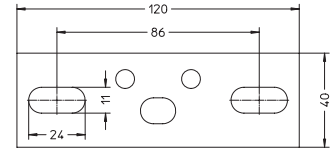
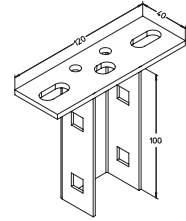

BGU 57 head plate, profile U57

Head plate for ceiling mounting of bracket support KHU 57

article number	H mm	B mm	L mm	t mm	G kg
F					
BGU 57F	100	40	160	5	0,54

accessories included:

- 2 x **FRSV 10x20F** cup square neck bolt
- 2 x **US 10x21F** Square washer, DIN 125
- 2 x **SEM 10F** hexagon-nut, DIN 934

article number	H mm	B mm	L mm	t mm	G kg
E					
BGU 57E	100	40	160	5	0,52

accessories included:

- 2 x **FRSV 10x20E** cup square neck bolt
- 2 x **US 10x21E** Square washer, DIN 125
- 2 x **SEM 10E** hexagon-nut, DIN 934

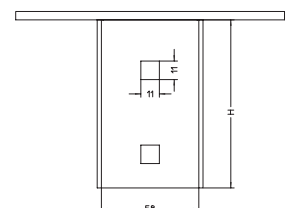
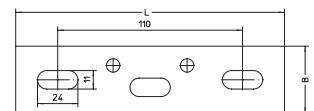
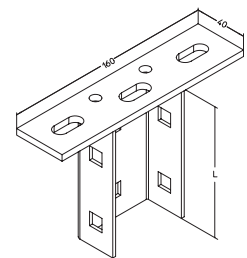

BGU 57 head plate, profile U57

Head plate for ceiling mounting of bracket support KHU 57

article number	H mm	B mm	L mm	t mm	G kg
E4					
BGU 57E4	100	40	160	5	0,52

accessories included:

- 2 x **FRSV 10x20E4** cup square neck bolt
- 2 x **US 10x21E4** Square washer, DIN 125
- 2 x **SEM 10E4** hexagon-nut, DIN 934

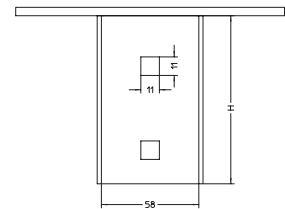
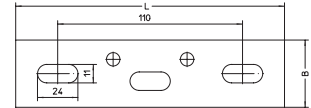
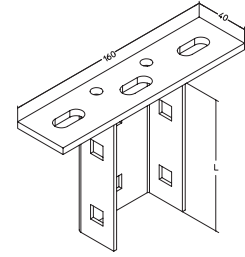

KHUV 40 coupler

article number	H mm	B mm	L mm	t mm	G kg
S					
KHUV 40S	45	32	210	2,5	0,45

accessories included:

- 4 x **SEM 10** hexagon-nut, DIN 934
- 4 x **US 10x21** Square washer, DIN 125
- 4 x **FRSV 10x20** cup square neck bolt

article number	H mm	B mm	L mm	t mm	G kg
F					
KHUV 40F	45	32	210	2,5	0,47

accessories included:

- 4 x **SEM 10F** hexagon-nut, DIN 934
- 4 x **US 10x21F** Square washer, DIN 125
- 4 x **FRSV 10x20F** cup square neck bolt

article number	H mm	B mm	L mm	t mm	G kg
E					
KHUV 40E	45	32	210	2,5	0,45

accessories included:

- 4 x **SEM 10E** hexagon-nut, DIN 934
- 4 x **US 10x21E** Square washer, DIN 125
- 4 x **FRSV 10x20E** cup square neck bolt

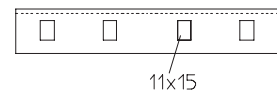
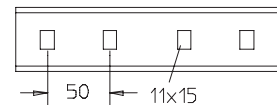
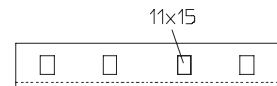
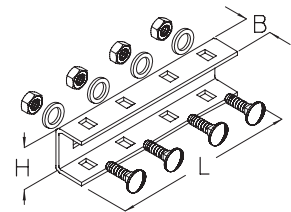

That's new.

KHUV 40 coupler

article number	H mm	B mm	L mm	t mm	G kg
E4					
KHUV 40E4	45	32	210	2,5	0,46

accessories included:

- 4 x **SEM 10E4** hexagon-nut, DIN 934
- 4 x **US 10x21E4** Square washer, DIN 125
- 4 x **FRSV 10x20E4** cup square neck bolt

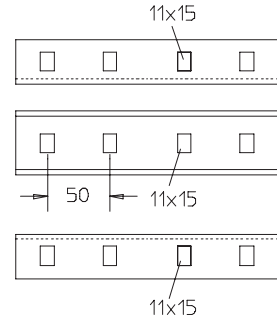
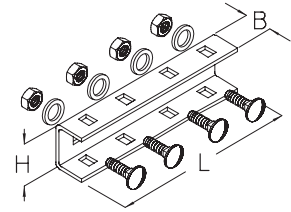

KHUV 57 coupler

article number	H mm	B mm	L mm	t mm	G kg
S					
KHUV 57S	63	32,5	210	2,5	0,60

accessories included:

- 4 x **SEM 10** hexagon-nut, DIN 934
- 4 x **US 10x21** Square washer, DIN 125
- 4 x **FRSV 10x20** cup square neck bolt

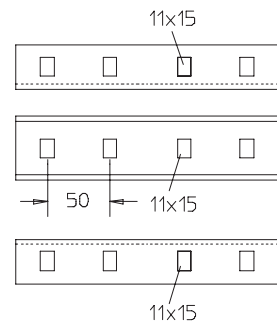
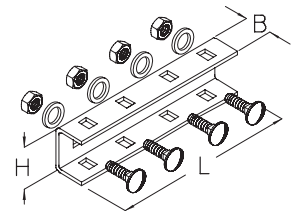

article number	H mm	B mm	L mm	t mm	G kg
F					
KHUV 57F	63	32,5	210	2,5	0,63

accessories included:

- 4 x **SEM 10F** hexagon-nut, DIN 934
- 4 x **US 10x21F** Square washer, DIN 125
- 4 x **FRSV 10x20F** cup square neck bolt

article number	H mm	B mm	L mm	t mm	G kg
E					
KHUV 57E	63	32,5	210	2,5	0,60

accessories included:

- 4 x **SEM 10E** hexagon-nut, DIN 934
- 4 x **US 10x21E** Square washer, DIN 125
- 4 x **FRSV 10x20E** cup square neck bolt

article number	H mm	B mm	L mm	t mm	G kg
E4					
KHUV 57E4	63	32,5	210	2,5	0,61

accessories included:

- 4 x **SEM 10E4** hexagon-nut, DIN 934
- 4 x **US 10x21E4** Square washer, DIN 125
- 4 x **FRSV 10x20E4** cup square neck bolt

KHUSS 40 support piece

article number	G
	kg

S	
KHUSS 40S	0,11

accessories included:

1 x SEM 10	hexagon-nut, DIN 934
2 x US 10x21	Square washer, DIN 125
1 x SES 10x75	Hexagon head bolt, DIN 933

article number	G
	kg

F	
KHUSS 40F	0,11

accessories included:

1 x SEM 10F	hexagon-nut, DIN 934
2 x US 10x21F	Square washer, DIN 125
1 x SES 10x75F	Hexagon head bolt, DIN 933

article number	G
	kg

E	
KHUSS 40E	0,11

accessories included:

1 x SEM 10E	hexagon-nut, DIN 934
2 x US 10x21E	Square washer, DIN 125
1 x SES 10x75E	Hexagon head bolt, DIN 933

article number	G
	kg

E4	
KHUSS 40E4	0,11

accessories included:

1 x SEM 10E4	hexagon-nut, DIN 934
2 x US 10x21E4	Square washer, DIN 125
1 x SES 10x75E4	Hexagon head bolt, DIN 933

KHUSS 57 support piece

article number	G
	kg

S	
KHUSS 57S	0,14

accessories included:

1 x SEM 10	hexagon-nut, DIN 934
2 x US 10x21	Square washer, DIN 125
1 x SES 10x100	Hexagon head bolt, DIN 933

article number	G
	kg

F	
KHUSS 57F	0,14

accessories included:

1 x SEM 10F	hexagon-nut, DIN 934
2 x US 10x21F	Square washer, DIN 125
1 x SES 10x100F	Hexagon head bolt, DIN 933

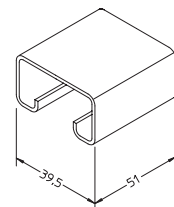
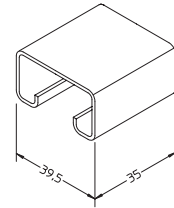

That's new.

KHUSS 57 support piece

article number	G	kg
E		
KHUSS 57E		0,14

accessories included:

- 1 x **SEM 10E** hexagon-nut, DIN 934
- 2 x **US 10x21E** Square washer, DIN 125
- 1 x **SES 10x100E** Hexagon head bolt, DIN 933

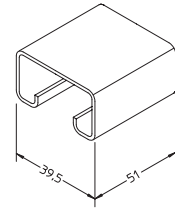

article number	G	kg
E4		
KHUSS 57E4		0,14

accessories included:

- 1 x **SEM 10E4** hexagon-nut, DIN 934
- 2 x **US 10x21E4** Square washer, DIN 125
- 1 x **SES 10x100E4** Hexagon head bolt, DIN 933

SU 40 protection cap

article number	B	G
	mm	kg
PE		
SU 40	44	0,01

accessories optional:

- KDU 40** KDU 40 bracket support, 40 x 30mm
- KHU 40** KHU 40 bracket support, 40 x 30mm

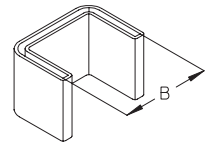

SU 57 protection cap

article number	B	G
	mm	kg
PE		
SU 57	61	0,02

accessories optional:

- KDU 57** KDU 57 bracket support, 57 x 30mm
- KHU 57** KHU 40 bracket support, 57 x 30mm

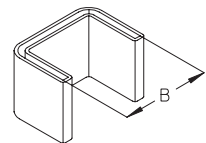

That's new.

KWMS wall bracket, medium duty

F_D/P : coefficient for calculation of the dowel load F_D with effective bracket load P respectively the sum of effective bracket loads.

article number	H mm	B mm	L mm	P_{max} kN	F_D/P	G kg
F						
KWMS 010F	85	100	120	3,8	1,36	0,53
KWMS 020F	85	200	220	3,8	1,81	0,76
KWMS 030F	85	300	320	3,8	2,32	0,99
KWMS 040F	85	400	420	3,8	2,86	1,21
KWMS 050F	85	400	420	3,8	3,42	1,43
KWMS 060F	85	600	620	3,8	3,99	1,65
KWMS 070F	85	700	720	2,9	5,68	1,88
E						
KWMS 010E	85	100	120	3,8	1,36	0,60
KWMS 020E	85	200	220	3,8	1,81	0,82
KWMS 030E	85	300	320	3,8	2,32	1,03
KWMS 040E	85	400	420	3,8	2,86	1,25
KWMS 050E	85	400	420	3,8	3,42	1,46
KWMS 060E	85	600	620	3,8	3,99	1,68
E4						
KWMS 010E4	85	100	120	3,8	1,36	0,60
KWMS 020E4	85	200	220	3,8	1,81	0,82
KWMS 030E4	85	300	320	3,8	2,32	1,03
KWMS 040E4	85	400	420	3,8	2,86	1,25
KWMS 050E4	85	400	420	3,8	3,42	1,46
KWMS 060E4	85	600	620	3,8	3,99	1,68

accessories optional:

- KDU 57** KDU 57 bracket support, 57 x 30mm
- KHU 57** KHU 40 bracket support, 57 x 30mm
- SD** straddling dowel
- KLR** clamping assembly
- ALS-BS** Bracing support

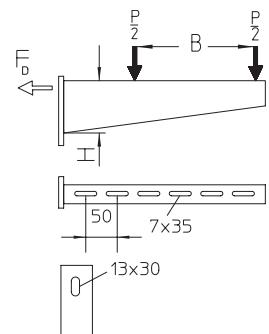
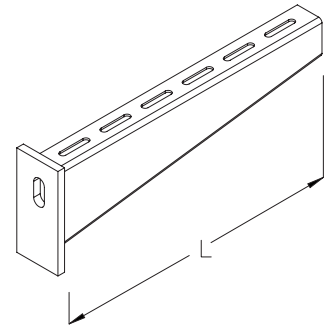

Not available anymore.

To make space for our new products, we will remove the following product groups.

KHU 50

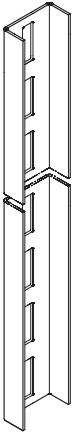

KDU 50

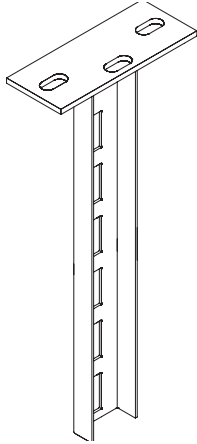

KDU 52

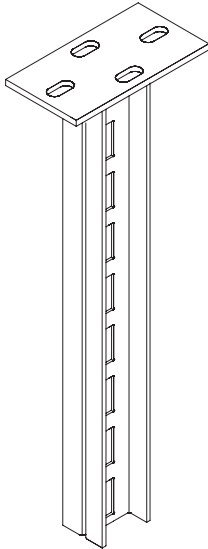

KHU 100

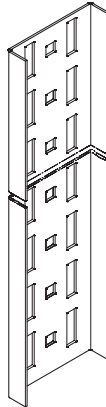

KDU 102

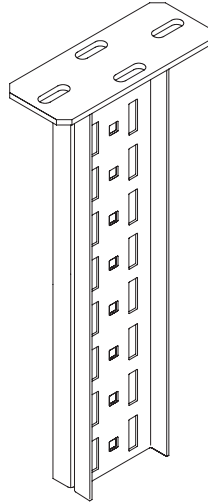

KUL

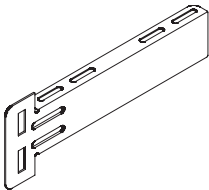

KUM

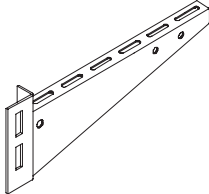

KUS

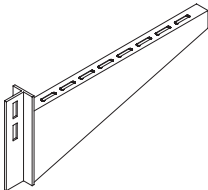

BGU 50

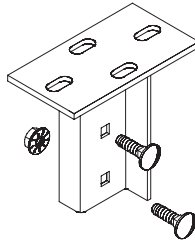

BGU 100

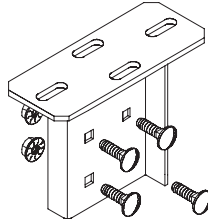

Options for Combination – KHU

KHU 40 with bracket KWF

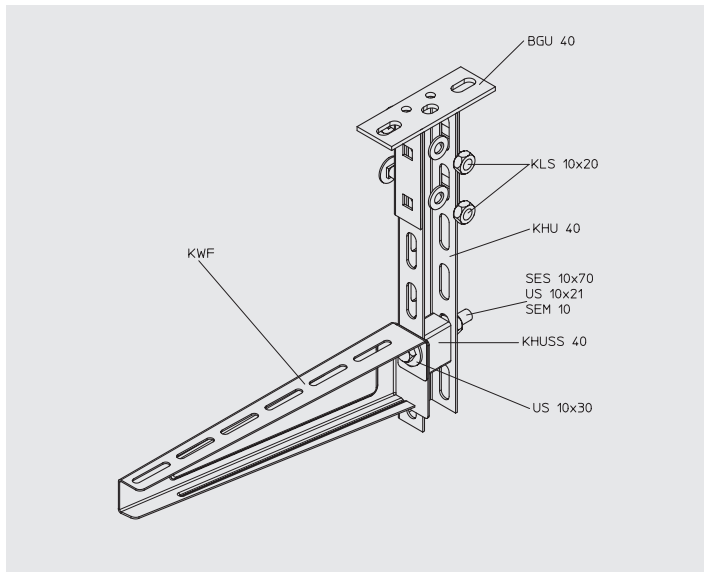

KHU 40 with bracket KW

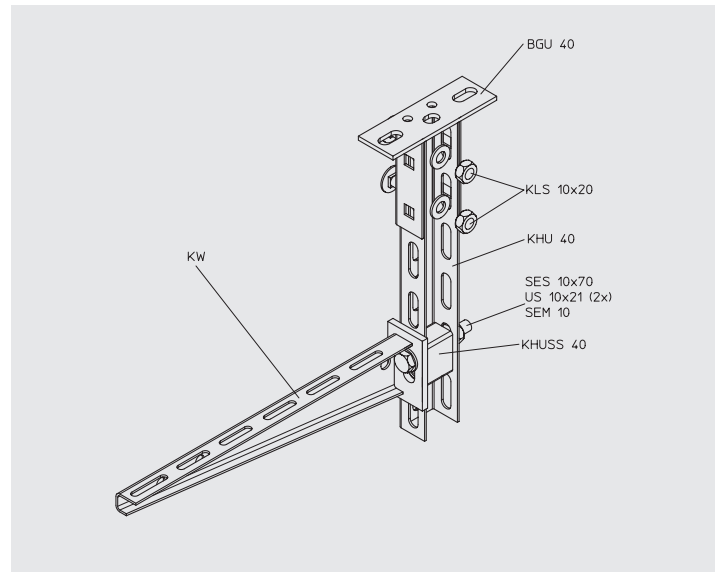

KHU 57 with bracket KWF

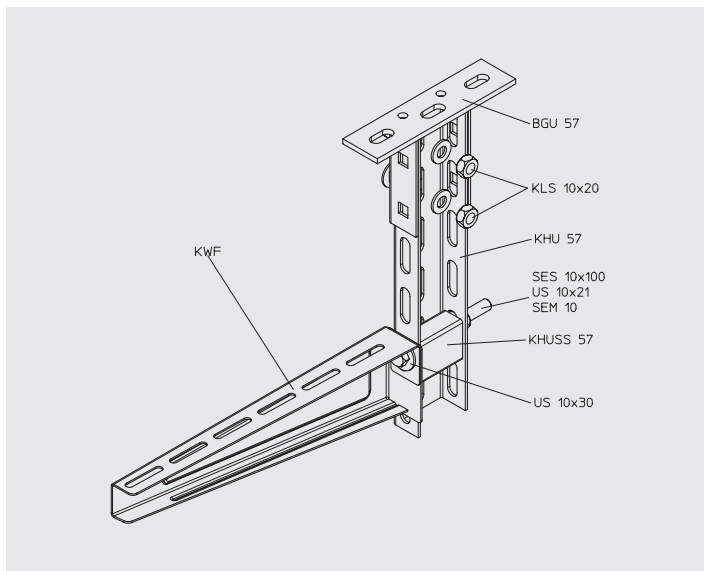

KHU 57 with bracket KW

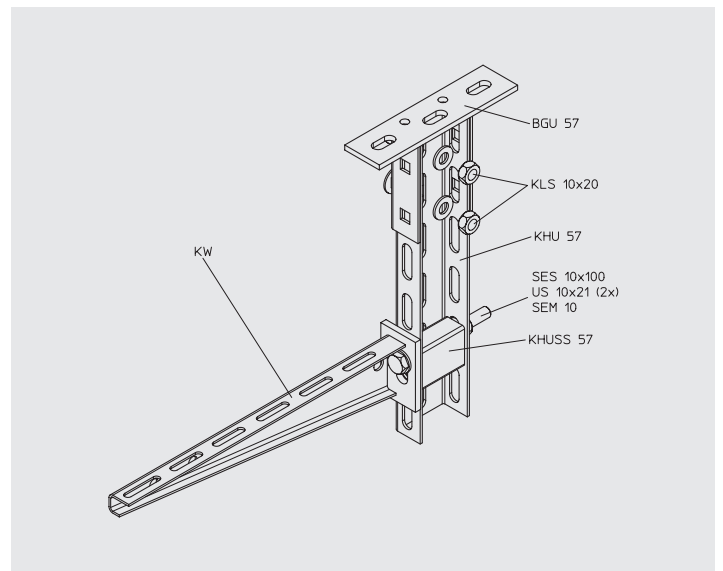

KHU 57 with bracket KWMS

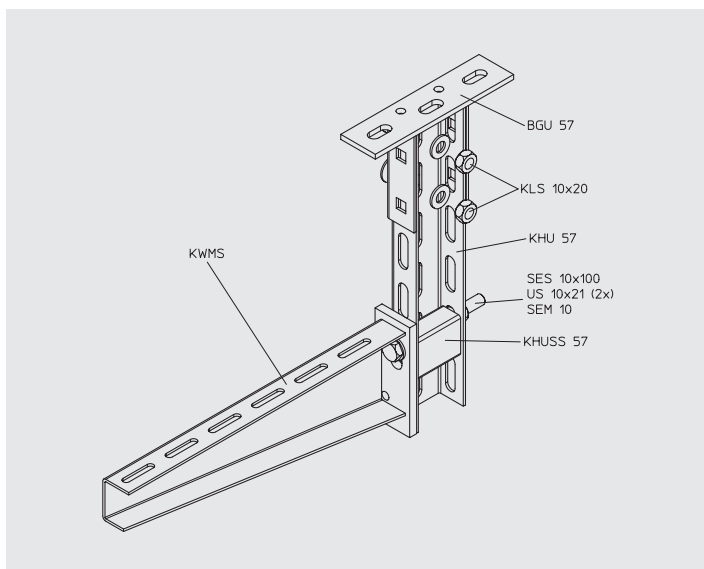

KHU 60 with bracket KWF

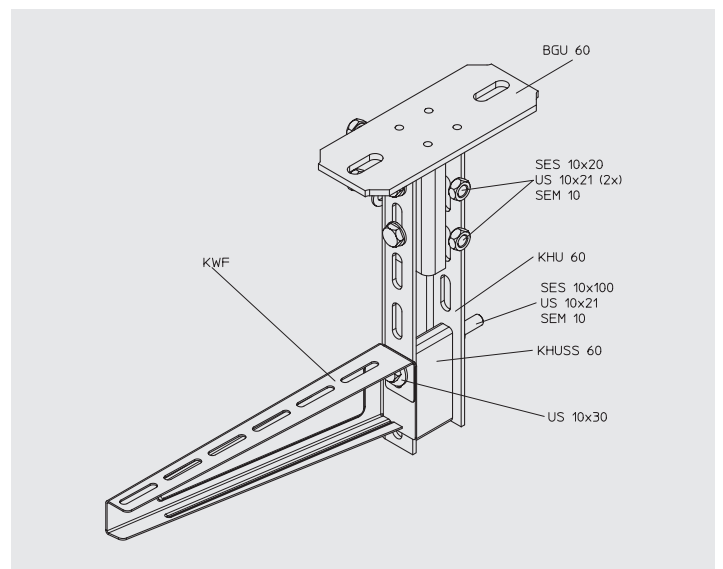

KHU 60 with bracket KW

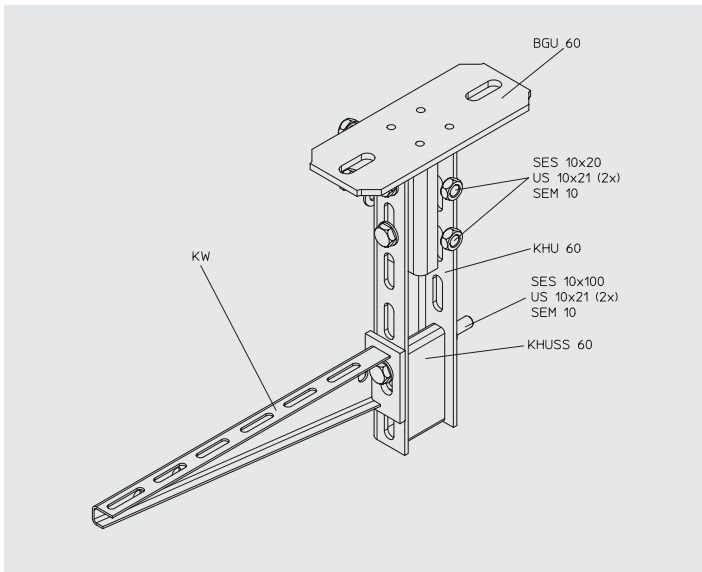

KHU 60 with bracket KWMS

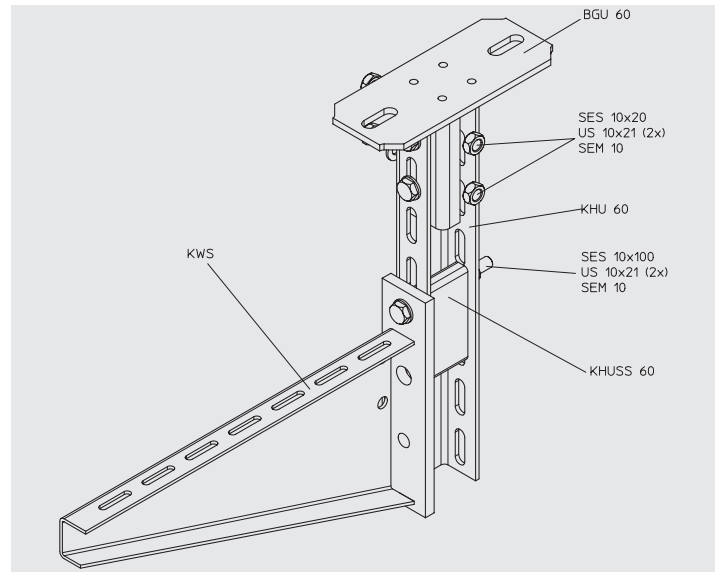

KHU 60 with bracket KWS

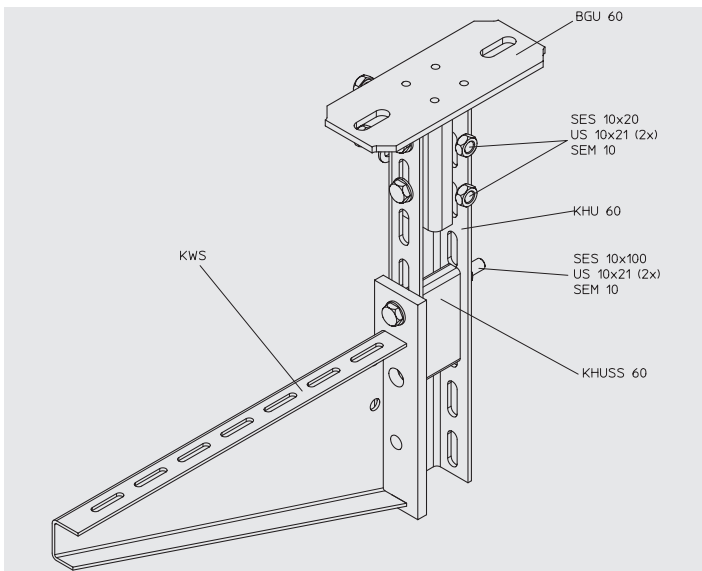

Options for Combination – KDU

KDU 40 with bracket KWF

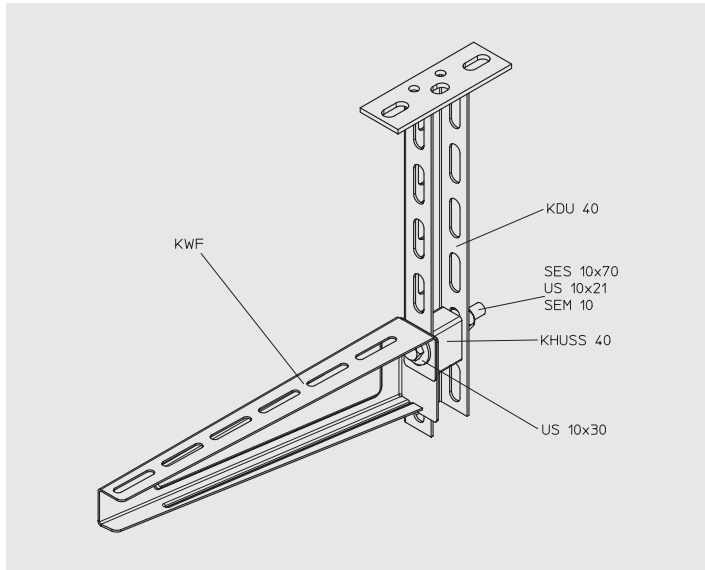

KDU 40 with bracket KW

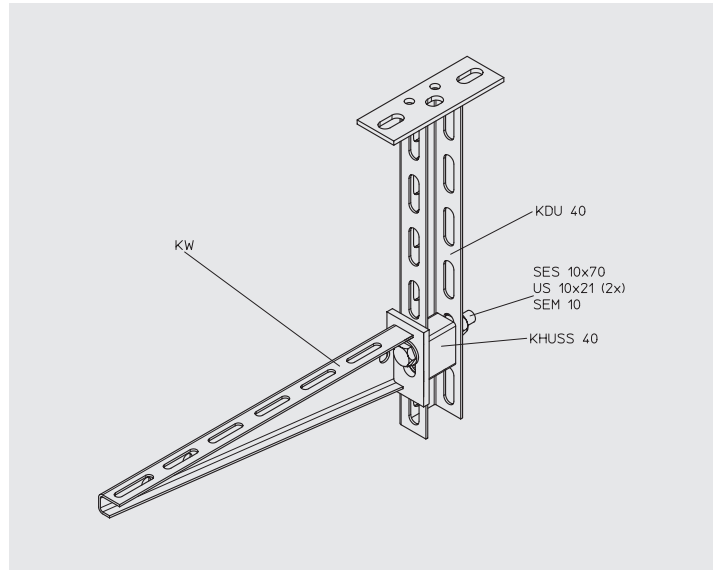

KDU 57 with bracket KWF

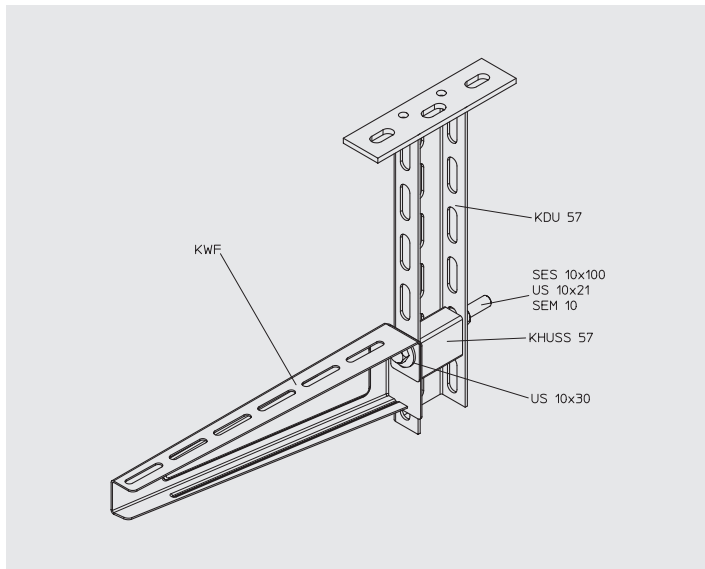

KDU 57 with bracket KW

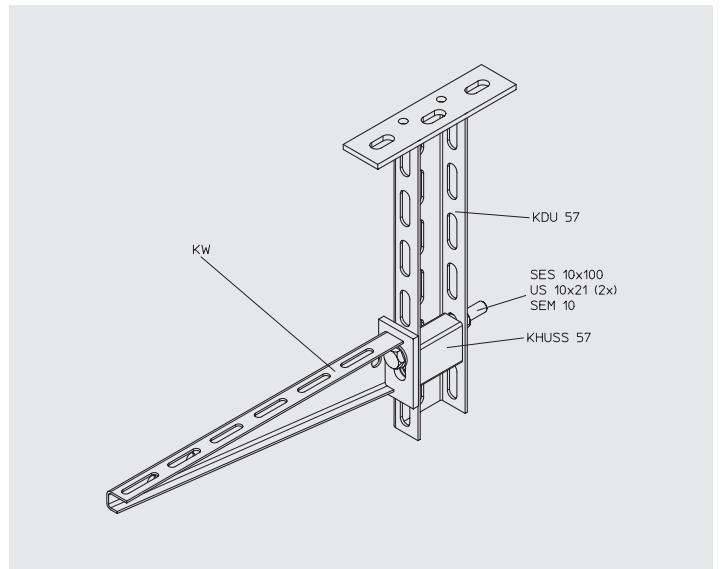

KDU 57 with bracket KWMS

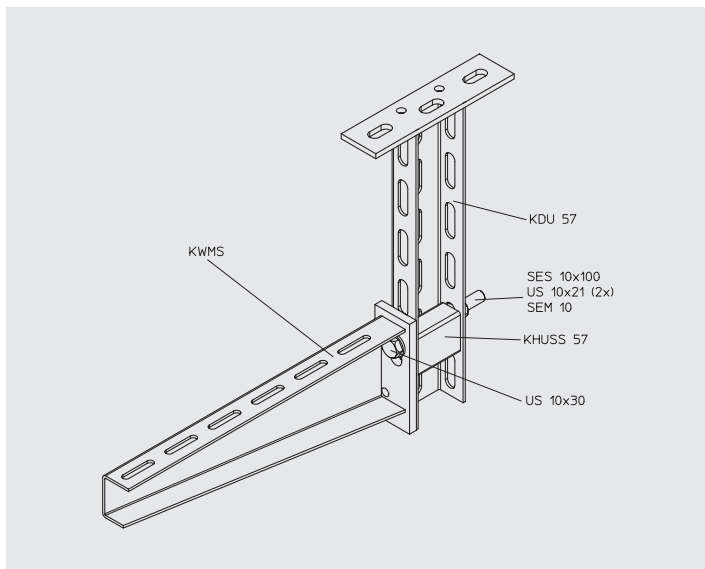

KDU 60 with bracket KWF

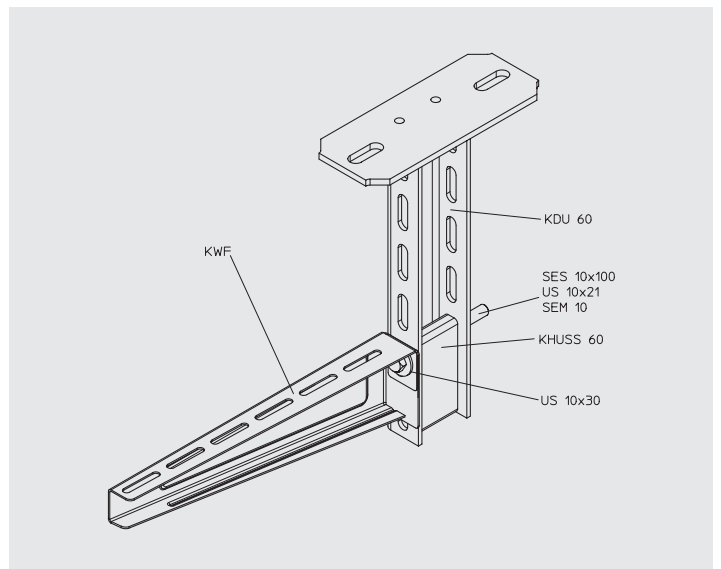

KDU 60 with bracket KW

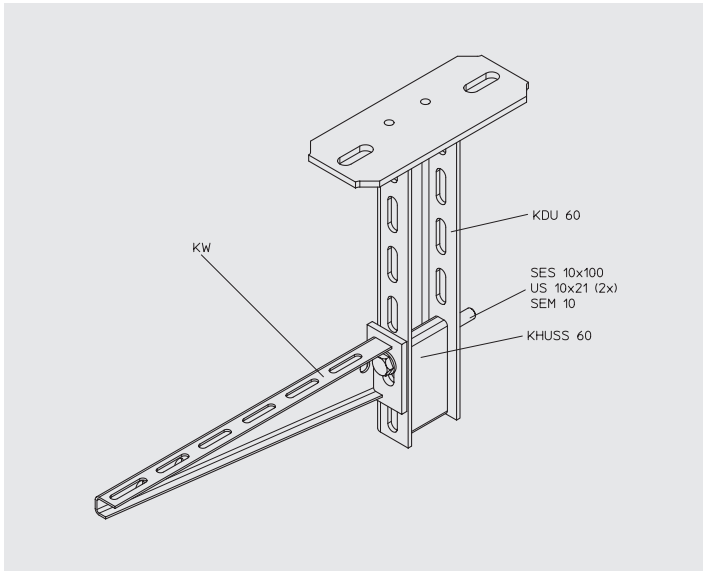

KDU 60 with bracket KWMS

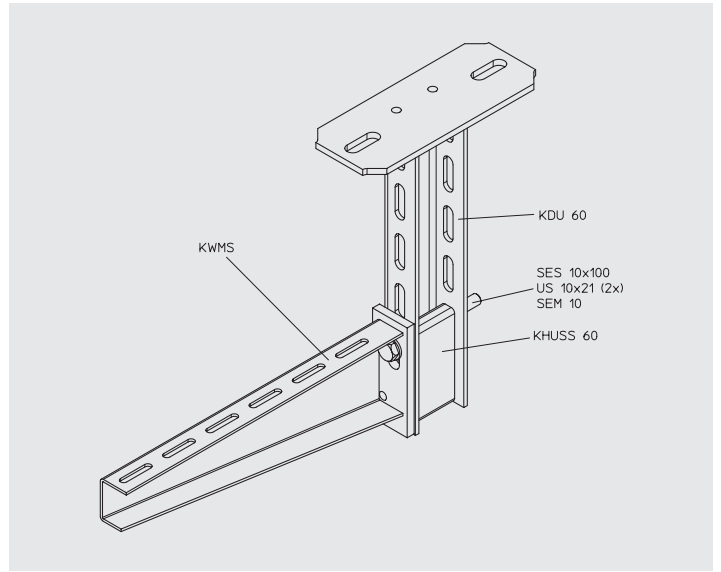

KDU 60 with bracket KWS

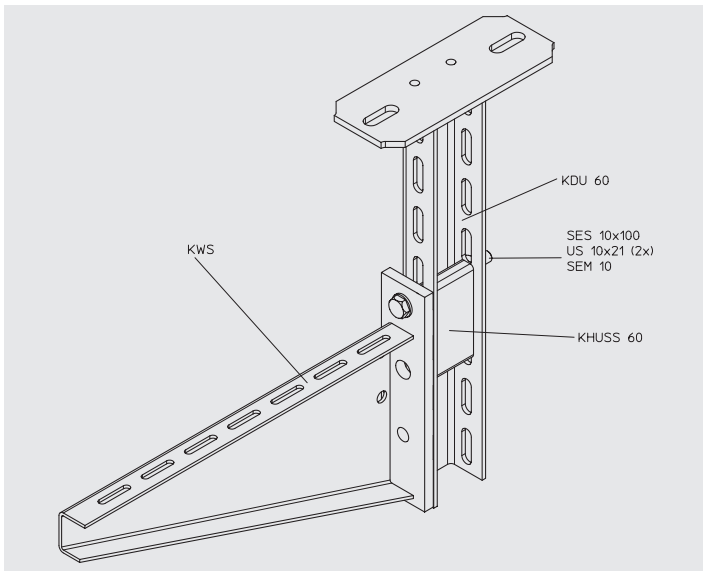

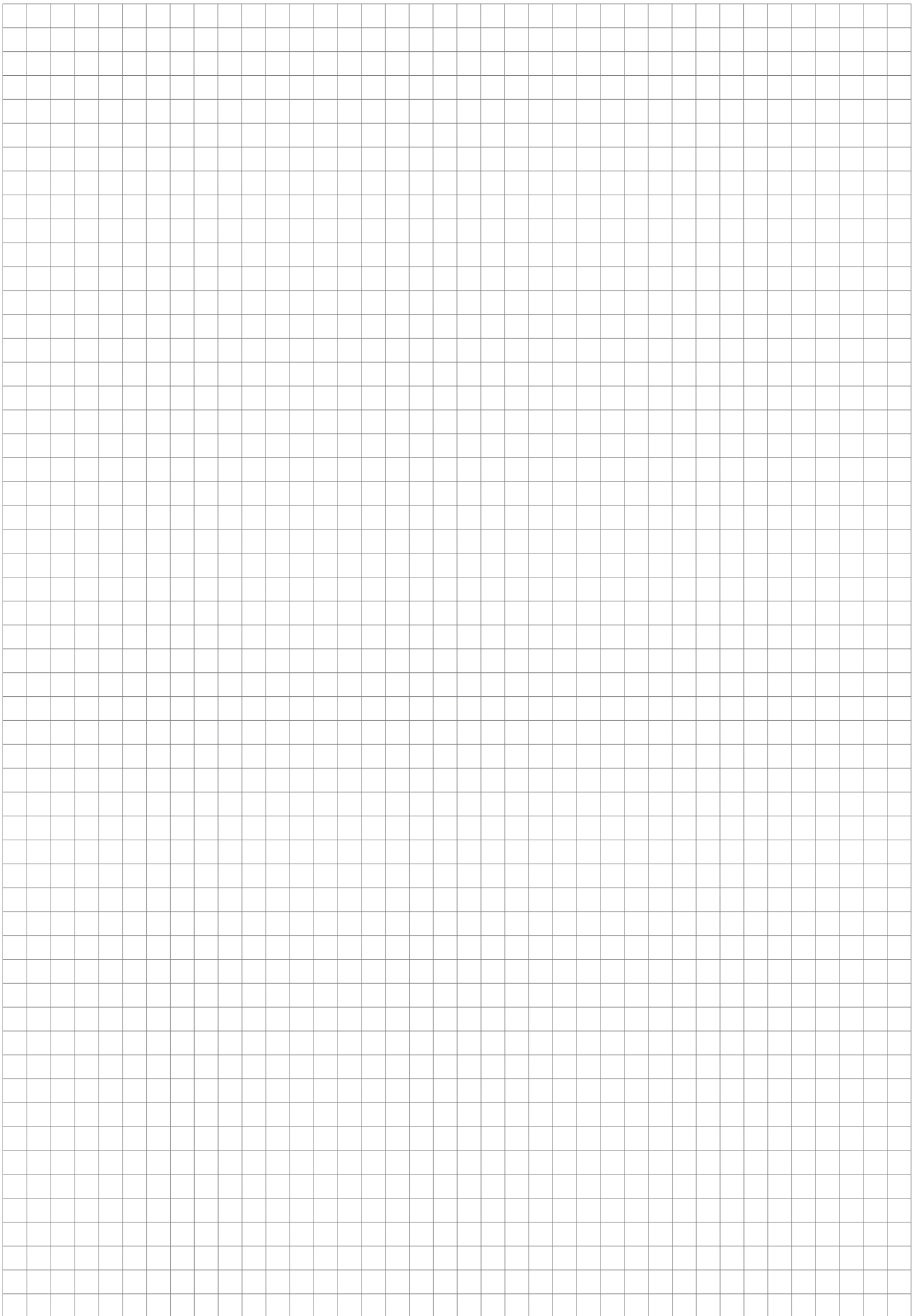

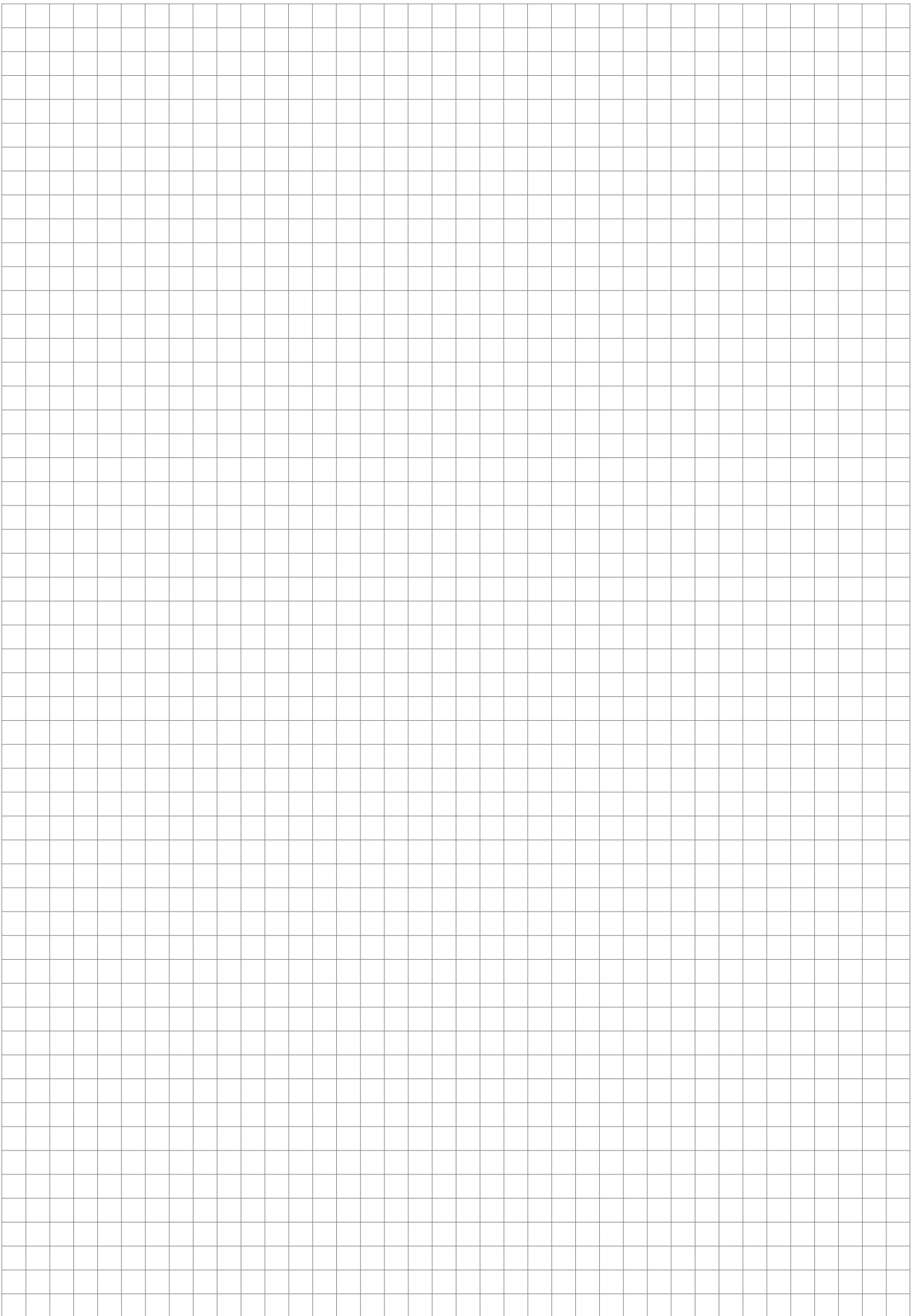



Errors and technical modification subject to change. Reproduction as well as electronic duplication only with our written permission. With appearance of this print all preceding documents lose their validity.

